

1/2" – 6"

SSP Sight Glasses are ideally suited as reliable flow indicators for virtually all existing process media in either liquid or even gaseous state.

Modular Design

The Sight Glasses are available with glass window plates made of Borosilicate acc. to DIN 7080 as per standard.

The sturdy design bodies are made of cast steel 1.0619 (WCB), coating RAL 5005 signal-blue or stainless steel casting 1.4408 (CF-8M), with resistant linings such as PFA or PFA-AS (conductive).



SSP
Body 1.0619 (WCB)/PFA

Main Features

- Heavy-duty, proven construction - maintenance-free
- Horizontal or vertical installation, flange connection acc. to ANSI 150lbs (DIN optional)
- No need of additional flange gaskets due to wide and chambered flange sealing surface
- Standard drip ledge indicating even minute flows
- Large observation opening

 **Conformity according to European Pressure Equipment Directive 2014/68/EU (PED)**

Options

- Metal reinforced glass plates
- Quartz glasses
- FEP glass protection sheet
- Visual flow indicator for gases (PTFE ribbon)

Operating Conditions

- Temperature range from -40°F up to +400°F, depending on lining material
- Pressure range from 0.01 psia up to 232 psi, depending on size/pressure/temperature

Testing / Marking

- Pressure- and tightness testing acc. to EN 12266-1, leakage rate A, resp. API 598.
- Marking of valves on body and name plate acc. to EN 19.
- Material- resp. test certificates acc. to EN 10204-3.1/2.2/2.1

Pressure-/Vacuum/Temperature Diagram

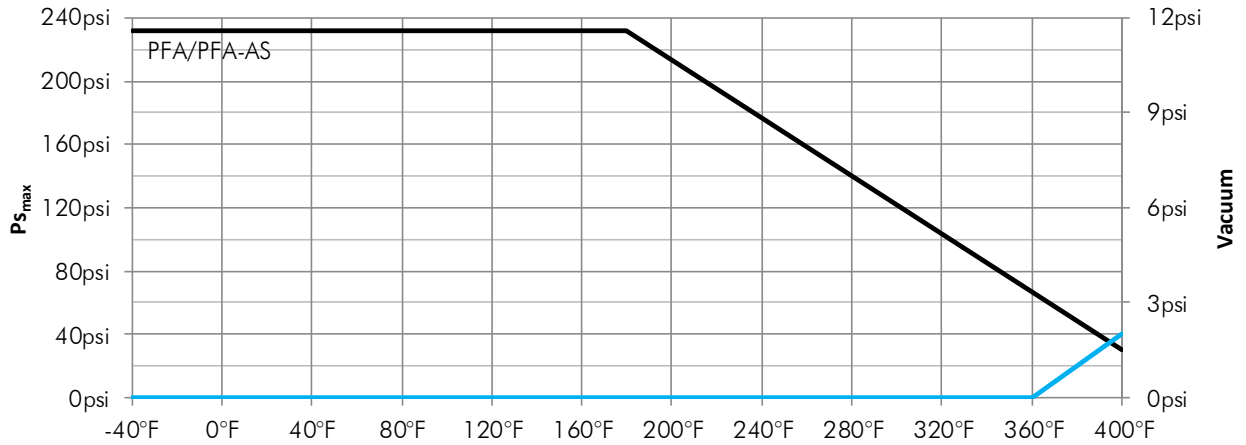

Low temperature or austenitic steels are required for use below 14°F operating temperature.

Technical Data

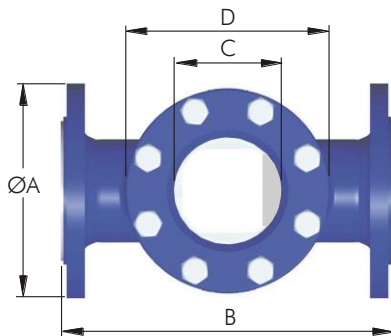

Standard Materials of Components

- Body** Cast Steel 1.0619 (WCB) 5005 epoxy
- Flange** Cast Steel 1.0619 (WCB) 5005 epoxy
- Lining** PFA (opt. PFA-AS conductive)
- Glass Plate** Borosilicate 8488 acc. to DIN 7080
- Gasket** C-4400 asbestos-free
- Bolts** SS304

Dimensions inch

Size nom.	1/2"	3/4"	1"	1 1/2"	2"	2 1/2"	3"	4"	6"
ØA	3.74	4.13	4.25	5.00	6.00	7.00	7.50	9.00	11.00
B	5.12	5.91	6.00	7.00	8.00	8.50	9.50	11.50	14.00
ØC	1.30	1.30	1.89	2.56	3.15	3.15	3.94	4.92	7.87
D	□2.76	□2.76	□3.35	□4.33	□4.72	Ø6.89	Ø7.48	Ø8.27	Ø11.42
ØGlass	1.77x0.39	1.77x0.39	2.48x0.39	3.15x0.47	3.94x0.59	3.94x0.47	4.92x0.79	5.90x0.98	8.86x1.18
Weight lbs	7.92	9.24	11.00	16.72	25.96	40.48	55.00	99.88	122.54

F/F acc. to ASME B16.10, other sizes and materials upon request
 Body flanges: 2 1/2" and 3" ANSI with tapped holes 5/8" UNC, 6" ANSI with threaded holes 3/4" UNC
 F/F options: 2 1/2", 3" and 6" available with DIN lengths

Standard Version (Picture showing DN 80 PN16, PFA-lined)

Parts List Sight Glass compl.

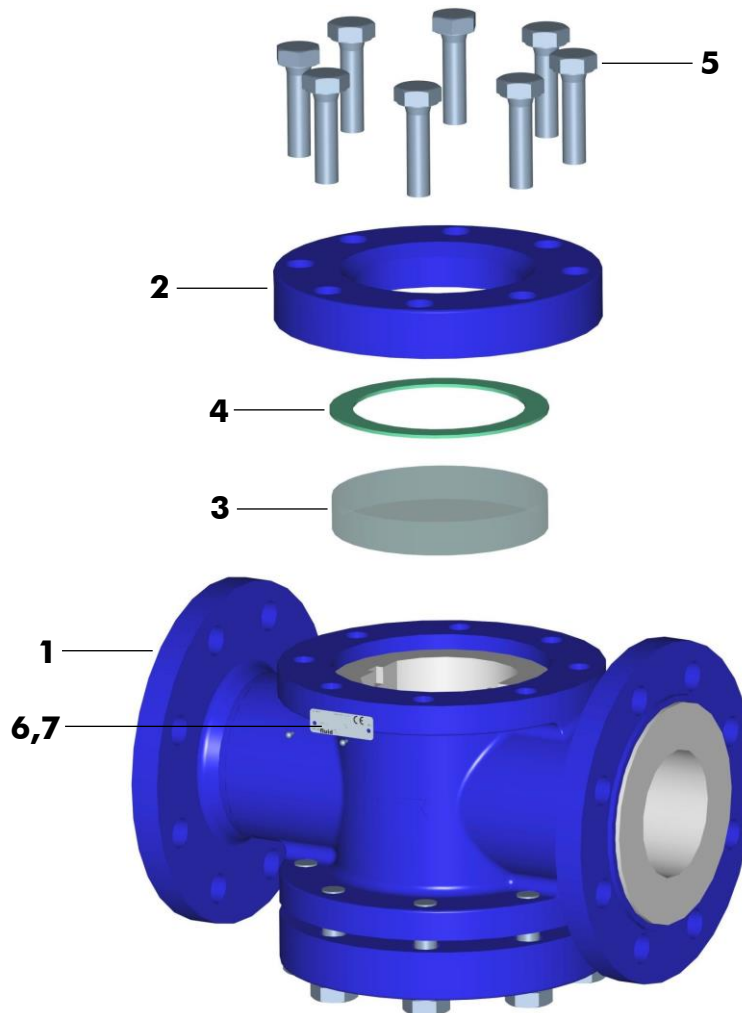

Item	Qty.	Description	Material	No.
1	1	Body PFA-lined, RAL 5005	WCB	1.0619
2	2	Flange, RAL 5005	WCB	1.0619
3	2	Glass Plate DIN 7080	Borosilicate	8488
4	2	Gasket	C-4400	
5	16	Hex. Head Screw	A2-70	1.4310
6	1	Name Plate 42 x 14 CE	A2	1.4301
7	2	Hammer Screw 2.49 x 4.76	A2	1.4310

Specifcaton

Project-/Customer Data		Inquiry/Date: _____		Ref. SF _____	
Company:	_____	Contact Person:	_____	Phone:	_____
Address:	_____	Function:	_____	Fax:	_____
ZIP/Place:	_____	Department:	_____	E-mail:	_____
Project:	_____	Phone direct:	_____	Mobile:	_____

Operating Conditions
Media / Chemical Composition:

<input type="checkbox"/> liquid	<input type="checkbox"/> powdery	<input type="checkbox"/> crystallizing	<input type="checkbox"/> sticky	<input type="checkbox"/> Spec. Grav. _____
<input type="checkbox"/> gaseous	<input type="checkbox"/> Solids ____ %	<input type="checkbox"/> viscous	<input type="checkbox"/> Flow Velocity _____ ft/sec	
<input type="checkbox"/> abrasive	<input type="checkbox"/> Particle ____ mm	<input type="checkbox"/> Visc. _____ cp	<input type="checkbox"/> Flow Rate _____ usg/min	

Pressure

 max. ____ bar
 min. ____ bar

Temperature

 max. ____ °C
 min. ____ °C

Mode
 On/Off
 Flow Control
 ____ cycles/ ____

Installation / Environment
 horizontal
 vertical

 Room dry
 Room humid
 outdoor

Remarks: _____

SSP Product Code

Specification of a complete Sight Glass SSP Series

Product code	Nom. size	Flange conn.	Body	Lining body	Glass plate	Options
SSP	2"	150#	G10	A85	Gb	
	½" - 6" DN15 - 150	ANSI150# ANSI300# PN16 PN40 JIS 10K	G10 WCB G15 CF-8M	A85 PFA A86 PFA-AS	Gb Glass plate PN16 Gb40 Glass plate PN40 Gr reinforced glass Gq Quartz glass	Op visual flow ind. RAL... special paint