

THERMODYNAMIC

This type of trap uses steam dynamic energy to close the discharge orifice. A disc closes both the inlet and outlet orifice. Condensate can lift the disc and be discharge, but when steam is formed its dynamic energy will create a low pressure area (Bernulli Law) under the disc which draws it towards the seat.

MAIN FEATURES

Reduced dimension and weight simple and reliable. It discharges air. It withstands waterhammer. Condensate discharge is intermittent. Some loss of live steam.

APPLICATIONS

- Ironing machines
- Steam mains
- Tracing lines
- Turbines
- Marine applications
- Presses

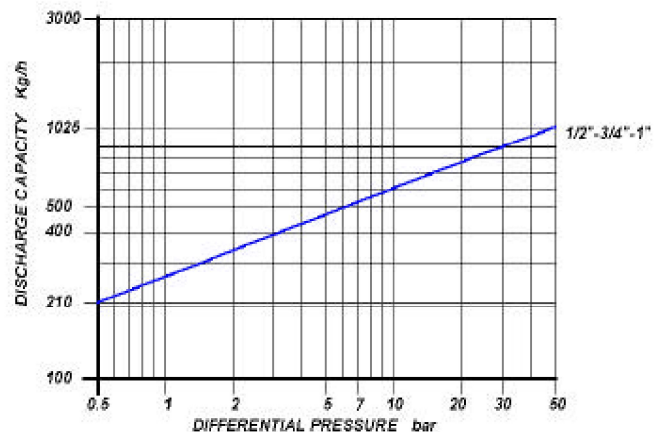
DISCHARGE CAPACITY

Cold water capacities are 2 to 4 times greater than the above .
Safety factor = 1.2 – 1.5

SIZES

1/2" – 3/4" – 1"

CONNECTIONS

Screwed	ANSI B1.20.1 (NPT) / BS21 (BSP)
Socket Welding	ANSI B 16.11

LIMITING CONDITIONS (according to ISO 6552)

Steam Trap rating	ANSI 300
PMA: Max allowable pressure	50 bar
TMA: max allowable temperature	500°C
PMO: max working pressure	50 bar
TMO: max working temperature	380°C

THERMODYNAMIC STEAM TRAPS DF

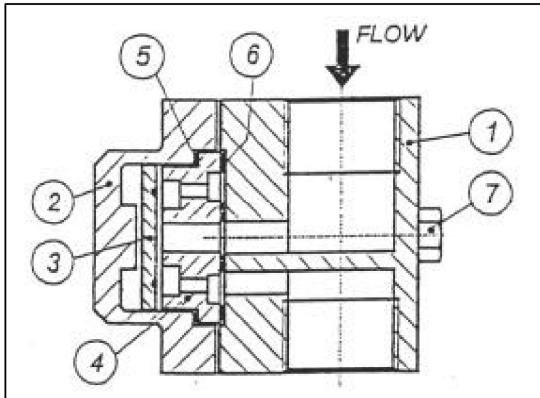

POS.	DESCRIPTION	MATERIALS	SPARES
1	Body	ASTM A 182 F304	
2	Cover	ASTM A 182 F304	X
3	Disc	AISI 431	X
4	Seat	AISI 431	
5	Gasket	Non asbetos material	
6	Gasket	Non asbetos material	
7	Bolts	ASTM A 193 B 8	

Size (inches)	S	A	B	C	Weight (Kg)
½"	60	78	60	70	1.5
¾"	60	78	60	70	1.5
1"	68	83	62	80	1.8

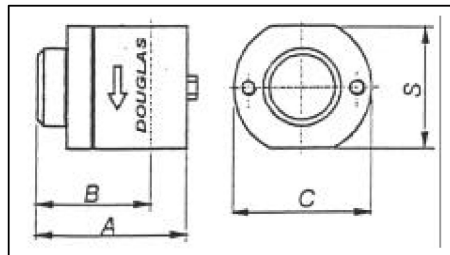

INSTALLATION

The steam trap can be installed in any position, however it should be preferably fitted on horizontal pipelines.

HOW TO SERVICE

By installing a new seat-disc assembly you can bring the steam trap to the "as new from factory" condition. This operation is carried out in a few minutes without removing steam trap from the pipeline. Unscrew cover (2) and remove disc(3), seat(4) and clean the inside of the trap. Put in new parts. Scew on cover(2) using a high temperature grease.

NOTE

The thermodynamic steam trap DF can be installed on the same connector of our inverted bucket steam trap mod. IF. Please contact our technical departement.

How to order: i.e.

DOUGLAS ITALIA S.p.A Località Pradaglie – 29013 CARPANETO PIACENTINO (PC)

OFFICIAL WEB SITE: www.douglas-italia.com